

# GETTING STARTED

800-0283  
RT 11-01-05

**NOTE:** Before you start running your new Mini-LST, it is absolutely necessary that you read through all of the operating instructions to get the maximum enjoyment and prevent unnecessary damage.

## Step 1



Plug the AC charger into the proper wall receptacle(110V). Plug the battery pack into the charger and let it charge for 3 hours for the first time. After running until the Mini-LST slows noticeably recharge the battery pack for 5-6 hours for a full charge.

## Step 2



Remove the transmitter battery cover by sliding the cover from left to right. Install eight (8) AA batteries into the battery holder. Pay close attention to the correct direction of the positive (+) and negative (-) ends as marked in the tray. Once all 8 batteries have been installed, reinstall the battery cover by sliding it on from right to left.

## Step 3

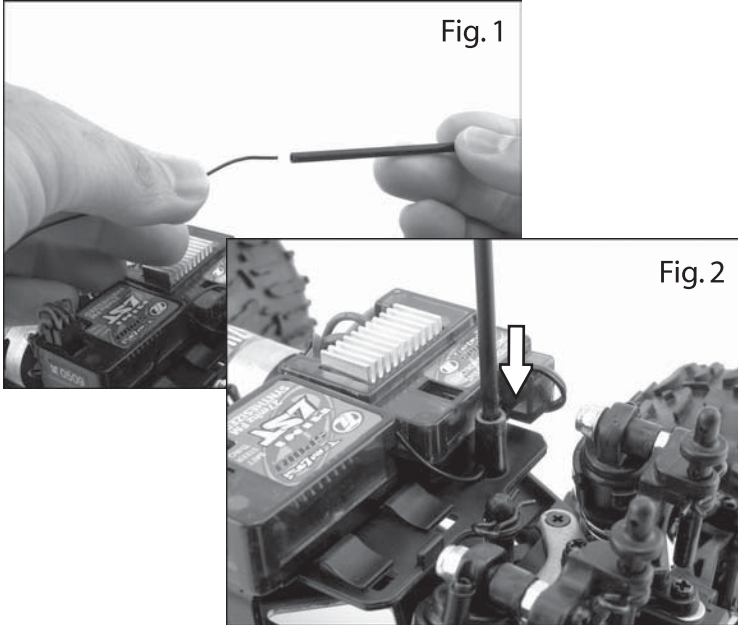

Insert the antenna wire through the antenna mount and into the antenna tube (fig 1.) pushing it through until it comes out the other end. Push the antenna tube (fig 2.) into the antenna mount.

## Step 4

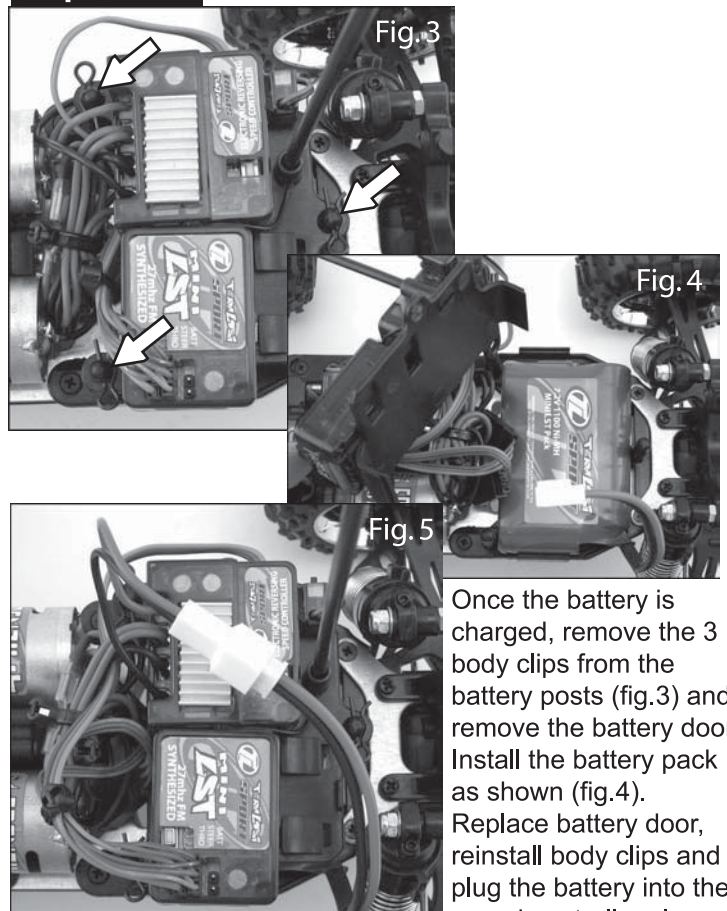

Once the battery is charged, remove the 3 body clips from the battery posts (fig.3) and remove the battery door. Install the battery pack as shown (fig.4). Replace battery door, reinstall body clips and plug the battery into the speed controller plug. (fig.5)

### Customer Support Contacts:

<b>Electronics/Motor/Battery</b>	<b>Mini LST Chassis Components:</b>
Horizon Hobby Inc.	Team Losi
4105 Fieldstone	4710 E. Guasti Road
Champaign, IL 61821	Ontario, CA 91761
1-877-504-0233	1-888-899-LOSI (5674) Fax 909-390-5356

**Continued on next page** ➡

## Step 5



Always turn on the transmitter first by sliding the switch on the left side of the wheel from left to right. The small red and green lights above the switch should both light up. If not you need to check for low or incorrectly installed batteries.

## Step 7

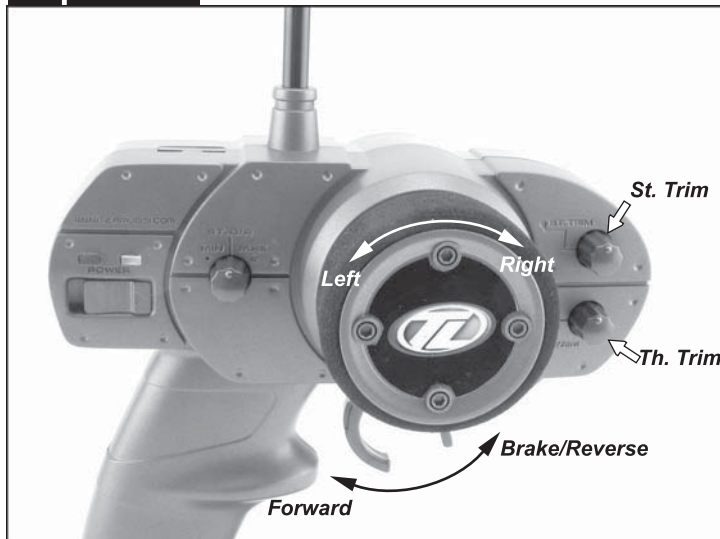

Once the transmitter has been turned on, turn on the Mini-LST by sliding the switch on the speed controller to the "On" position. If the rear wheels turn, adjust the "TH. Trim" knob located to the lower right of the steering wheel until they stop. To go forward pull the trigger back. If you should need reverse, wait for the model to stop then push the trigger forward. When going forward the model should move in a straight line. If not, adjust the "ST. TRIM" so that it tracks in a straight line with out having to turn the steering wheel.

After you are done running, turn the Mini-LST off **FIRST** by sliding the switch to the off position. After the model has been turned off, turn off the transmitter. If you wish to clean your Mini-LST, use compressed air and/or a soft paintbrush to remove dust and dirt. **NEVER** use chemicals or anything wet as it can cause damage to both electronics and plastic parts.

## Step 6



### Frequency/Channel Guide

Channel/Color	Frequency	LED Indicators
Ch. 1 (Brown)	26.095mhz	Red (top) only
Ch. 2 (Red)	27.045mhz	Yellow (middle) only
Ch. 3 (Orange)	27.095mhz	Red & Yellow (top & middle)
Ch. 4 (Yellow)	27.145mhz	Green (bottom) only
Ch. 5 (Green)	27.195mhz	Red & Green (top & bottom)
Ch. 6 (Blue)	27.225mhz	Yellow & Green (middle & bottom)

**Although your Mini-LST frequency has been set from the factory, it is suggested that they be checked before use.**

Both the transmitter and the receiver must be set to the same frequency/channel for the model to operate correctly. This can be easily checked by noting the colored LED's (lights) on the top of the receiver and the back of the transmitter. These should always be the same on both or you will not have control of the model. Always program the transmitter first then the receiver. To select a frequency follow the following easy steps.

1. Turn on the transmitter and/or receiver. Note that both should display the same colored light(s).
2. Locate the frequency selector button.
3. Press the selector button until the desired frequency light(s) are light.
4. Repeat for the receiver if necessary.
5. Double check to make sure both the transmitter and receiver have the same LED's (lights) on.

## ALWAYS

- Turn on the transmitter before the truck
- Use caution when running around people
- Turn both the Mini-LST and transmitter "off" when done
- Check the battery condition of the transmitter before running

## NEVER

- Operate the Mini-LST with low battery power.
- Run the Mini-LST through water or wet grass
- Use chemicals to clean the chassis
- Run the Mini-LST without a gear cover

### Customer Support Contacts:

**Electronics/Motor/Battery**  
**Horizon Hobby Inc.**  
 4105 Fieldstone  
 Champaign, IL 61821  
 1-877-504-0233

**Mini LST Chassis Components:**  
**Team Losi**  
 4710 E. Guasti Road  
 Ontario, CA 91761  
 1-888-899-LOSI (5674) Fax 909-390-5356

# Mini-LST Trouble Shooting Guide

Doesn't Operate	Battery not charged or connected properly Radio transmitter and receiver no on same frequency ESC Switch no "on" or broken Transmitter no "on" or low battery
Motors run but wheels don't move	Slipper too loose Gears stripped in center gearbox Gear stripped in front and/or rear gearbox Spur gear stripped Pinion gear setscrews loose Drive pins in axles/wheels missing
Steering doesn't work	Servo plug improperly installed in receiver or unplugged Bind in steering Servo or receiver damaged
Won't turn in one direction	Servo gears broken Steering linkage broken or bound
Motors do not run	Motor plugs loose Motor wire broken Motors bound or broken ESC damaged
ESC gets hot	Motors over geared Shorted Motor Driveline bound / Dirty
Poor run time / sluggish acceleration	Batteries low or shorted Charger not allowing full charge Slipper adjustment set too loose (slipping too much) Motors worn out Driveline bound / Dirty ESC needs to be programmed
Poor range / glitches	Transmitter batteries low Transmitter antenna loose Receiver antenna broken Battery pack in truck low Loose wires or plugs Transmitter and receiver not on same frequency
Slipper won't adjust	Drive pin missing in shaft Spur gear face worn out Adjuster nut stripped

## Customer Support Contacts:

**Electronics/Motor/Battery**  
**Horizon Hobby Inc.**  
**4105 Fieldstone**  
**Champaign, IL 61821**  
**1-877-504-0233**

**Mini LST Chassis Components:**  
**Team Losi**  
**4710 E. Guasti Road**  
**Ontario, CA 91761**  
**1-888-899-LOSI (5674) Fax 909-390-5356**

# PICK YOUR POWER

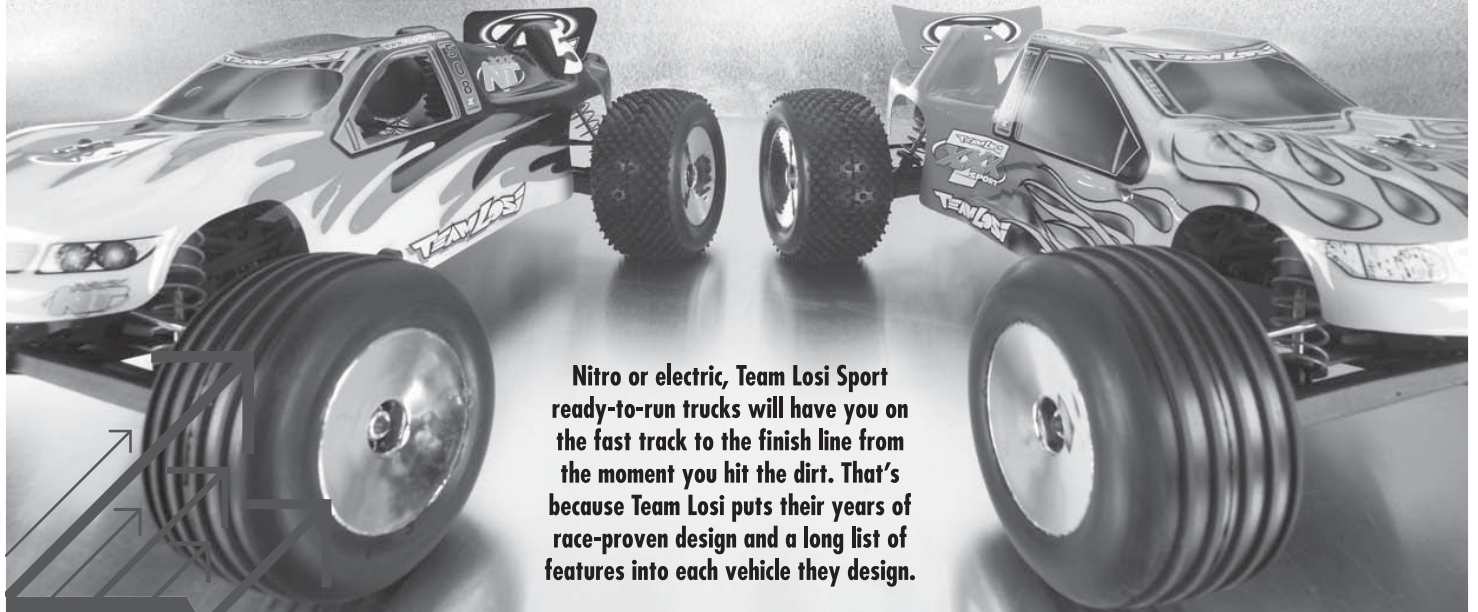

Nitro or electric, Team Losi Sport ready-to-run trucks will have you on the fast track to the finish line from the moment you hit the dirt. That's because Team Losi puts their years of race-proven design and a long list of features into each vehicle they design.

[WWW.TEAMLOSI.COM](http://WWW.TEAMLOSI.COM)

LOSA0887

## XXX-NT RTR II

Rear Exhaust Mach .15 Engine w/Electric Start



4.11:1 Low Stacked Transmission

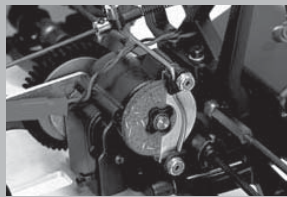

Whether you live for the smell of nitro, or you want the quiet power of electric, trust Team Losi's XXX-NT and XXX-T to put you light years ahead of the rest of the ready-to-run crowd.

LOSA0095

## XXX-T RTR II

Trinity 19-Turn Racing Motor

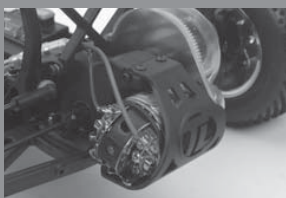

Novak-Engineered Electronic Speed Control



Both ready-to-run trucks from Team Losi come equipped with the JR® XR2i Programmable Radio System. Packed with features like Direct Access Digital Trims, sub-trim, steering dual rates, endpoint adjustments and more, the XR2i offers the perfect level of control and ease of use to get your truck set up and dialed in.

